

CITY

| NAME | LOCATION | NAME | LOCATION | NAME | LOCATION | NAME | LOCATION | NAME | LOCATION | NAME | LOCATION |
|---------------------------|----------|--------------------------------|----------|--------------------------------------|----------|-------------------------------|----------|--|----------|------------------------------|----------|
| ACCESSORIES | | APPAREL - MEN | | ELECTRONICS & ACCESSORIES | | GIFTS/BOOKS/CARDS/TOYS | | JEWELRY | | SHOES | |
| ANAHITA S PALACE | 214/306 | BROOKS BROTHERS | 226 | fye: MUSIC & MOVIES | 146 | A DOLLAR | 134 | ANAHITA S PALACE | 214/306 | ANN TAYLOR | 224 |
| ANN TAYLOR | 224 | CHAMPS SPORTS | 117 | GO! THE GAME STORE | 106 | AMERICAN GREETINGS | 119 | CHICK ET MODE | 150 | BROOKS BROTHERS | 226 |
| BROOKS BROTHERS | 226 | CYCLE LEATHER | 210 | GO! TOYS | 106 | ANAHITA S PALACE | 214/306 | CLAIRE S BOUTIQUE | 144 | CHAMPS SPORTS | 117 |
| CHARLOTTE RUSSE | 212 | FOOTBALL TOWN | 219 | IT S ABOUT TIME | 149 | BATH AND BODY WORKS/ | | CLEVELAND & BEYOND | 227 | CHARLOTTE RUSSE | 212 |
| CHICK ET MODE | 150 | FOOT LOCKER | 104 | REVOL | 139 | WHITE BARN CANDLE CO. | 221 | DAKOTA WATCH COMPANY | 180 | FOOT LOCKER | 104 |
| CLAIRE S BOUTIQUE | 144 | HARD ROCK CAFE | 216 | T-MOBILE | 158 | THE BODY SHOP | 208 | GOLD & DIAMONDS | 237 | FOREVER 21 | 133 |
| CLEVELAND & BEYOND | 227 | MERCHANDISE | 216 | WIRELESS FRIEND | 153 | BORDERS EXPRESS | 222 | GOLD STATION | 157 | JOHNSTON & MURPHY | 202 |
| CYCLE LEATHER | 209 | IDEAL | 220 | | | CHICK ET MODE | 150 | HARD ROCK CAFE | 216 | LADY FOOT LOCKER | 145 |
| FOREVER 21 | 133 | LAKE ERIE ARTISTS | 102 | ENTERTAINMENT | | CHRISTMAS CORNER | 106 | MERCHANDISE | 216 | NINE WEST | 225 |
| HARD ROCK CAFE | 216 | LOCKER ROOM SPORTS | 110 | TIME WARNER CABLE | 142 | CLAIRE S BOUTIQUE | 144 | ITALIAN JEWELRY | 159 | PAYLESS SHOE SOURCE | 109 |
| MERCHANDISE | 216 | SAUCE COUTURE | 108 | AMPHITHEATER AT TOWER CITY | | CLEVELAND & BEYOND | 227 | IT S ABOUT TIME | 149 | RAINBOW | 218 |
| IDEAL | 220 | SLV ABRUSH & DESIGN | 138 | TOWER CITY CINEMAS 11 | | DESIGNER PERFUMES | 209 | LAKE ERIE ARTISTS | 102 | RUBY S | 203 |
| LAKE ERIE ARTISTS | 102 | UNDERGROUND STATION | 135 | FOOD | | FOOTBALL TOWN | 219 | PHILANTHROPY ACCESSORIES | 112 | THE SHOE DEPARTMENT | 136 |
| LANE BRVANT | 116 | | | RESTAURANTS | | fye: MUSIC & MOVIES | 146 | ROGERS JEWELERS | 138 | UNDERGROUND STATION | 135 |
| LEVEL X | 217 | | | BICE RESTORANTE | 305 | GO! TOYS | 106 | WATCHES & THINGS | 236 | | |
| LIDS | 161 | | | HARD ROCK CAFE | 307 | GATEWAY NEWS | 230 | MISCELLANEOUS | | SPORTING GOODS | |
| PHILANTHROPY ACCESSORIES | 210 | | | HOUZHAN S | 301 | GO! THE GAME STORE | 106 | GUEST SERVICES | 156 | CHAMPS SPORTS | 117 |
| RAINBOW | 218 | | | IT S GREEK TO YOU! | 215 | HARD ROCK CAFE | 106 | TOWER CITY MANAGEMENT | 152 | CLEVELAND & BEYOND | 227 |
| RAVE | 111 | | | MORTON S THE STEAKHOUSE | 308 | MERCHANDISE | 216 | FOOTBALL TOWN | 219 | FOOT LOCKER | 104 |
| RUBY S | 203 | | | MUSE AT THE RITZ-CARLTON | 147 | LAKE ERIE ARTISTS | 102 | IDEAL | 220 | LADY FOOT LOCKER | 145 |
| SAUCE COUTURE | 108 | | | PANERA BREAD | 234 | PAPYRUS | 204 | LADY FOOT LOCKER | 145 | LOCKER ROOM SPORTS | 110 |
| UNDERGROUND STATION | 135 | | | TOWER 230 BAR & GRILLE | 223/303 | PHILANTHROPY ACCESSORIES | 210 | GATEWAY NEWS | 230 | RITA BUSSES | 300 |
| APPAREL - CHILDREN | | BANQUET & CATERING | | SPECIALTIES: | | ROGERS JEWELERS | 132 | HOLLYWOOD SHOT | 113 | PUBLIC SQUARE AND | 306 |
| CHAMPS SPORTS | 117 | FACILITIES | | AMERICAN GREETINGS | 119 | SAN FRANCISCO MUSIC BOX | 115 | LES AMIS SALON + SPA | 300 | PROSPECT AVENUE | 300 |
| THE CHILDREN S PLACE | 119 | BICE RESTORANTE | 305 | BAGEL ON THE AVENUE | 229 | THINGS REMEMBERED | 107 | MAC COSMETICS | 306 | RITA TRAINS | 300 |
| CHICK ET MODE | 150 | THE ENGLISH OAK ROOM | 137 | CARIBOU COFFEE | 233 | HOME FURNISHING | | NATIONAL CITY BANK & ATM | 209 | EAST, WEST, WATERFRONT LINES | 167 |
| CLEVELAND & BEYOND | 227 | BY EXECUTIVE CATERERS | 307 | CARVEL ICE CREAM | 105 | A DOLLAR | 134 | PORTICO SHOE SHINE | 232 | STATION COURT-LOWER LEVEL | 219 |
| CYCLE LEATHER | 209 | HARD ROCK CAFE | 307 | CHINA SON | 105 | BATH AND BODY WORKS/ | | PRINCE ALBERT S SHOE VALET | 167 | SPECIALTY CARTS/ | |
| FOOTBALL TOWN | 219 | HOUZHAN S | 301 | GOURMET POPPER | 215 | WHITE BARN CANDLE CO. | 221 | REVOL | 232 | SKYLIGHT CONCOURSE | |
| HARD ROCK CAFE | 216 | IT S GREEK TO YOU! | 215 | MRS. FIELDS | 155 | CLEVELAND & BEYOND | 227 | RESULTS DOWNTOWN FITNESS | 238 | CALENDAR CLUB | 140 |
| MERCHANDISE | 216 | MORTON S THE STEAKHOUSE | 308 | SWEET FACTORY | 103 | IT S ABOUT TIME | 149 | T-MOBILE | 158 | CHICK ET MODE | 140 |
| LOCKER ROOM SPORTS | 110 | MUSE AT THE RITZ-CARLTON | 147 | TEAM DINER: | | LAKE ERIE ARTISTS | 102 | TOWER CITY LOTTERY STOP | 242 | CHOPPERS/ZOOPETS | 140 |
| ANAHITA S PALACE | 214/306 | PANERA BREAD | 234 | ARBY S | 123 | MICHAEL ALDEN FURNITURE | 213 | TRADE SECRET | 142 | DEAD SEA SPA | 140 |
| ANN TAYLOR | 224 | SILVER GRILLE | 147 | AUNTE ANNE S PRETZELS | 126 | HOTELS | | U.S. POST OFFICE | 228 | ETCH-A-PHONE | 140 |
| BROOKS BROTHERS | 226 | BY THE RITZ-CARLTON, CLEVELAND | 223/303 | CAJUN & GRILL | 120 | RENAISSANCE CLEVELAND HOTEL | | U.S. POST OFFICE OUTLET | 211 | LIFE WORKS | 302 |
| CHAMPS SPORTS | 117 | TOWER 230 BAR & GRILLE | 223/303 | CHARLEY S GRILLED SUBS | 131 | THE RITZ-CARLTON, CLEVELAND | | FEDERAL EXPRESS DEPOSIT BOX, & UPS SERVICE STATION | 231 | LES AMIS | 300 |
| CHARLOTTE RUSSE | 212 | BEAUTY/HEALTH | | IT S GREEK TO YOU | 215 | (COMING SOON) | | VALET PARKING | 211 | SANTA S PEN | 300 |
| CHICK ET MODE | 150 | A DOLLAR | 134 | KENTUCKY FRIED CHICKEN | 124 | | | WATCHES & THINGS | 236 | SILVER MANIA I & II | 300 |
| CLEVELAND & BEYOND | 227 | BATH AND BODY WORKS/ | 201 | MASTER WAX | 120 | | | WIRELESS FRIEND | 153 | SKATE SHOES | 140 |
| CYCLE LEATHER | 209 | WHITE BARN CANDLE CO. | 221 | MCDONALD S | 129 | | | | | WRAP UP | 151 |
| FOOTBALL TOWN | 219 | THE BODY SHOP | 208 | MIXED GREENS | 129 | | | | | KRINGLE S TOY SHOPPE | 101 |
| FOOT LOCKER | 104 | DESIGNER PERFUMES | 205 | SABRO | 128 | | | | | | |
| FOREVER 21 | 133 | FASHION NAILS | 114 | SHANGHAI JOE | 122 | | | | | | |
| HARD ROCK CAFE | 216 | GNC | 207 | SMOOTHE THE AVENUE | 125 | | | | | | |
| MERCHANDISE | 216 | LES AMIS SALON + SPA | 300 | SUBWAY | 121 | | | | | | |
| IDEAL | 220 | MAC COSMETICS | 206 | TACO BELL | 124 | | | | | | |
| LADY FOOT LOCKER | 145 | RESULTS DOWNTOWN FITNESS | 238 | | | | | | | | |
| LAKE ERIE ARTISTS | 102 | TRADE SECRET | 142 | | | | | | | | |
| LANE BRVANT | 116 | | | | | | | | | | |
| LEVEL X | 217 | | | | | | | | | | |
| LOCKER ROOM SPORTS | 110 | | | | | | | | | | |
| PHILANTHROPY ACCESSORIES | 210 | | | | | | | | | | |
| RAINBOW | 218 | | | | | | | | | | |
| RAVE | 111 | | | | | | | | | | |
| RUBY S | 203 | | | | | | | | | | |
| SAUCE COUTURE | 108 | | | | | | | | | | |
| SLV ABRUSH & DESIGN | 138 | | | | | | | | | | |
| UNDERGROUND STATION | 135 | | | | | | | | | | |
| VICTORIA S SECRET | 201 | | | | | | | | | | |

Shop Dine Play Stay

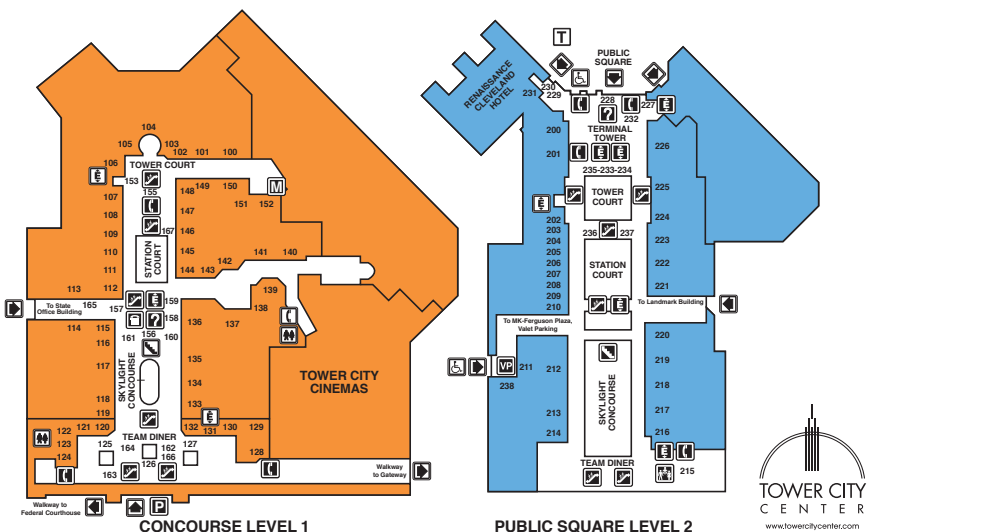

Give the gift that always fits—
A Tower City Center Gift Card...
Perfect for any occasion.

TOWER CITY CENTER
gift card
www.towercitycenter.com
Shop. Dine. Play. Stay.

Tower City Center
Saturdays and Sundays
Self-Park
Lots
Park Free
With Purchase
5 hours FREE

Weekly subscription discount available with \$25 purchase. For Final Terms and Conditions visit towercitycenter.com

Prospect Valet Station
\$8 Early Bird rate before 10 a.m.
\$7 Daily rate after 10 a.m.

TOWER CITY CENTER
eClub Exclusive Offers, Promotions and Contests

FREE MEMBERSHIP. Enjoy exclusive offers, promotions and contests, as well as updates about special events, store events, new stores and more. Sign up now to be part of the club. (You must be 18 or older to participate.)
VISIT OUR WEBSITE AT www.towercitycenter.com

WifiCITY
Your Wireless HOT-SPOT in Tower City Center

SPECIALTY LEASING
The Avenue at Tower City Center Invites You To Join Our Specialty Leasing Program

Your Ideas - Our Space
Make Your Dreams of Owning Your Own Business a Reality

Rent for a Week, Month or Year
Call: 1-216-771-6144

- LEGEND**
- ELEVATORS
 - ENTRANCE
 - ESCALATOR
 - GUEST SERVICES
 - HANDICAP
 - MANAGEMENT OFFICE
 - PARKING
 - RESTROOMS
HANDICAPPED ACCESSIBLE
 - FAMILY LOUNGE
 - STAIRS
 - TAXI STAND
 - TELEPHONES
 - TTY TELEPHONE
 - VALET PARKING